

# Coligo Installation Instructions



## WHAT YOU NEED:



Level



Tape Measure



Pencil/Painter's Tape



Tile Spacers

## PREP WORK:

Clean the surface on which the EcoPrivacy Acoustic™ Coligo panels will be mounted.

- Patch, trim, or level any uneven or damaged sections of the wall.
- Sand or wipe away grime. (Too much dirt on the wall might interfere with installation.)

Make sure your design won't interfere with ports or sockets. Move any ports or sockets where convenient.

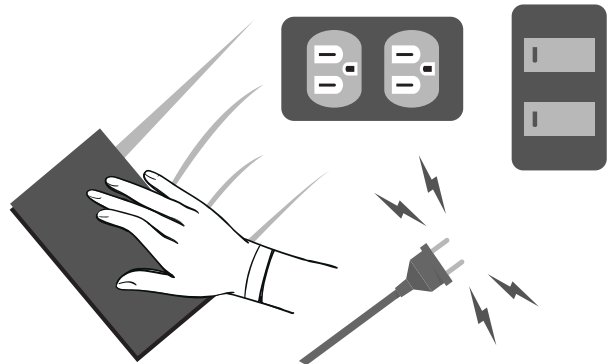

## INSTALLATION:

### 1. Find the center of the design

Using a tape measure, find the center of the design on the wall.  
For big walls or complex designs, divide the wall into grids of 2' by 3'



## 2. Mark the vertical and horizontal lines

With a level and a pencil or painter's tape, mark the vertical and horizontal lines from the panel center point.

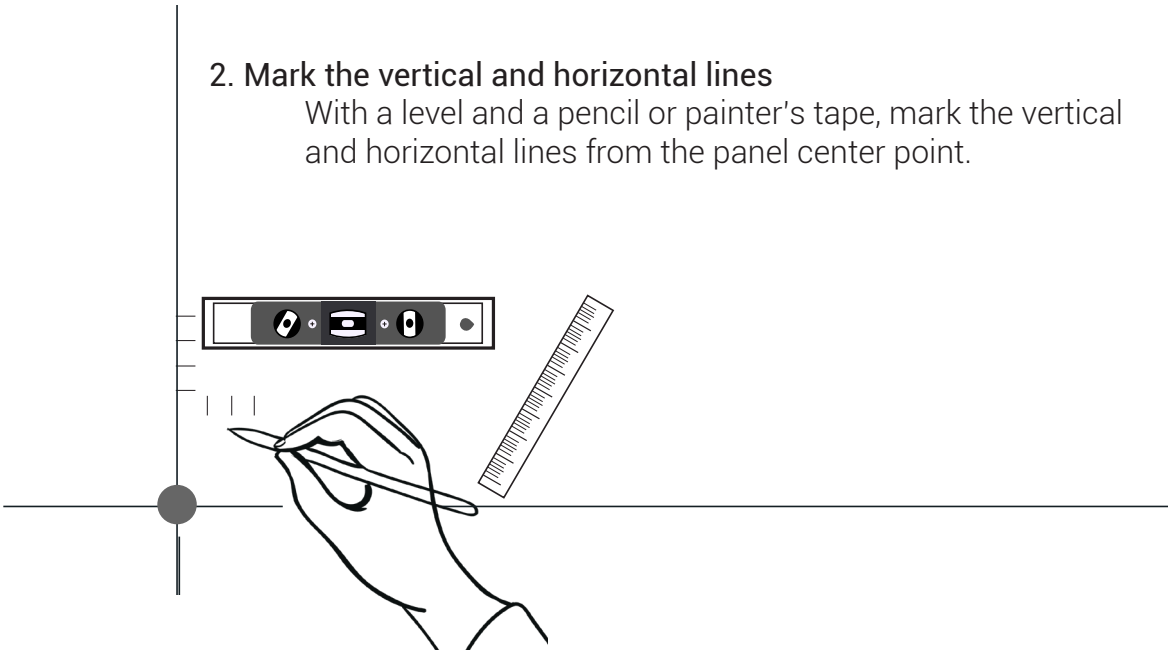

## 3. Lay out the design and adjust if needed

Starting at the center point, lay out the design on the wall, loosely installing the panels vertically and horizontally until you reach the side wall or the edge of your planned design. Use spacers for uniform joints.

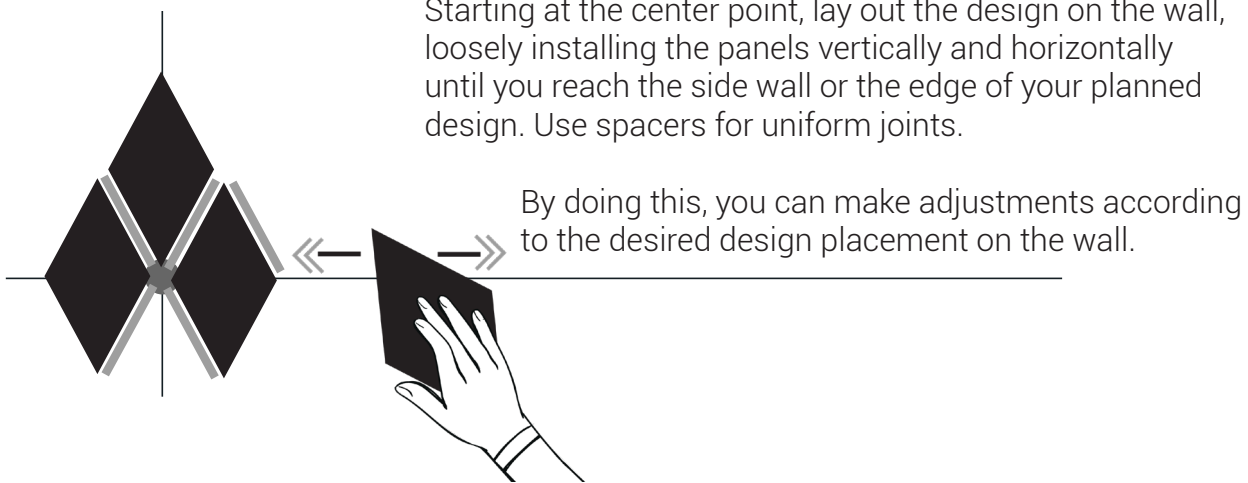

## 4. Apply adhesive and set the panels

Once you've finalized the layout and guides, begin to glue the panels onto the wall using the included construction adhesive.

